

**NOTIFICATION / UPDATES:**
**12 WEEKS NOTICE**
**10 DAYS NOTICE**
**IN PROGRESS**
**COMPLETION**
**INTERIM UPDATES**
**20/2/2019**
**A51 LICHFIELD ROAD, HOPWAS.**

Staffordshire County Council will shortly be carrying out significant works along the A51 Lichfield Road, Hopwas as they start work on a £340,000 investment in the local area. The team will be replacing damaged kerbs and resurfacing the carriageway between School Lane and Coton Lane Island.

**When are the works taking place?**

The work will commence on 1<sup>st</sup> April 2019.

**How long will the works take?**

Approximately 5 weeks to complete the works.

It would be much appreciated if you could ensure vehicles are not parked on the road during the day whilst the work is in progress. Should this cause any problems or concerns then please do not hesitate to call the number below or alternatively speak to the construction crew on site to allow arrangements to be put in place.

**Will I be able to access my home/business?**

Access to properties and businesses along the length of the works will be available throughout the job although may be restricted at times as we carry out these essential repairs outside each property.

**What effect could the works have on me?**

We take care to make sure that work is completed with the minimum of disturbance to the local community but as with any major works, some minor traffic delays may occur.

**How you can help us**

You can help us to get the job done with the minimum of fuss by following this advice:

- Please keep children away from the works to ensure their safety.
- Please drive appropriately through the works.
- Check your shoes before entering your property or car to make sure there is no bitumen from the works.

If you have any questions about the work or, concerns about how the work is being carried out, please do not hesitate to call our:

**Contact Centre on 0300 111 8000 calls charged at local rate or email**  
[highways@staffordshire.gov.uk](mailto:highways@staffordshire.gov.uk)

A3

© Crown copyright and database rights ### Ordnance Survey 100019422  
 You are not permitted to copy, sub-license, distribute or sell any of this data to  
 third parties in any form.  
 Produced by Staffordshire County Council, ####.

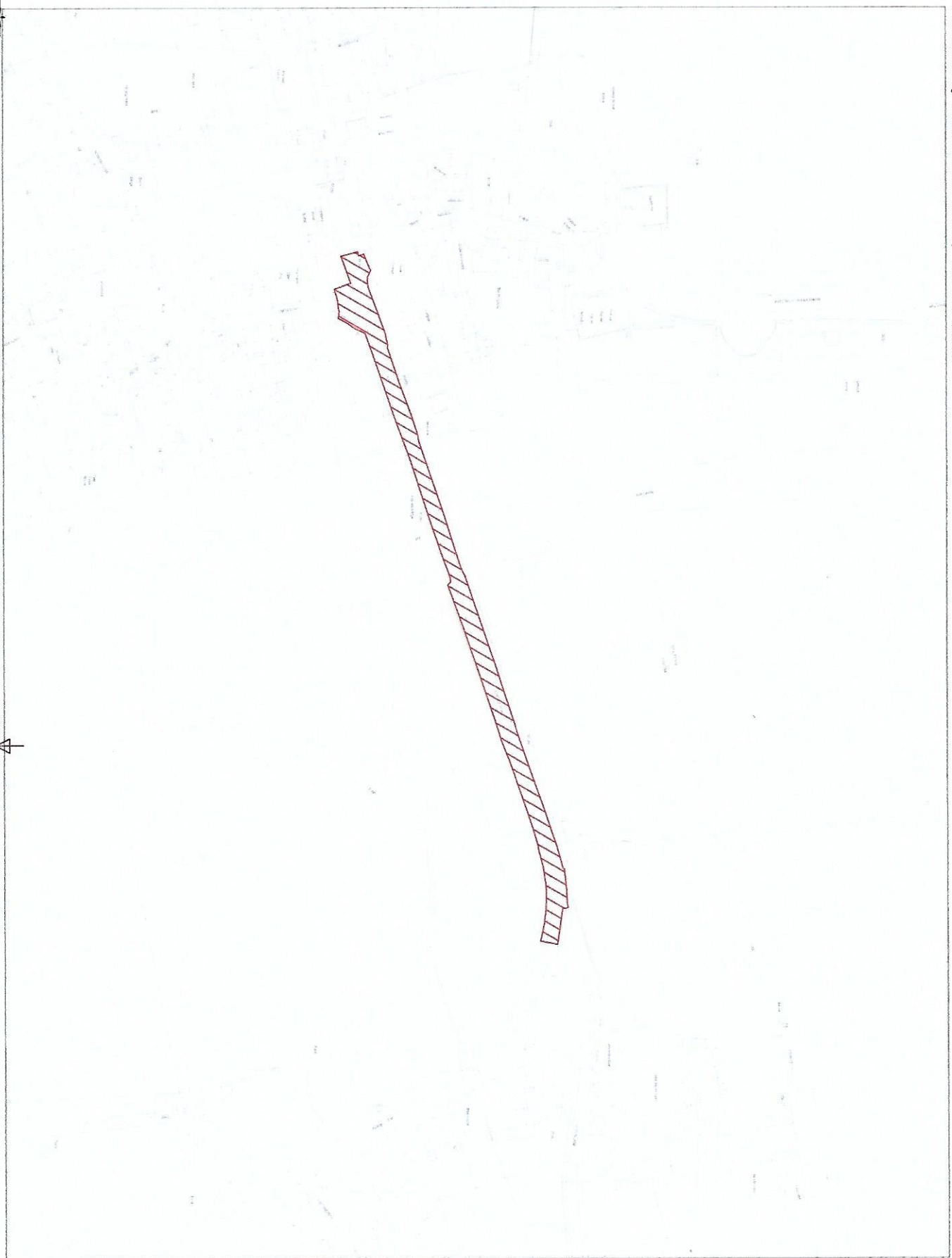

Rev	Detail	By	Date
Revisions			

Original Version	For approval	1
Design S.A.R.	For tender	
Design S.A.R.	For construction	
Date	February 2019	AS constructed
Checked by:		Other

Approved Use: Drawing NOT approved if this box is empty



Project Name  
**A51 Lichfield Road, Hopwas**

Drawing Title  
**Kerbing, Footway & Carriageway Scheme.**

Grid reference: BM  
 Original Drawing Size: A3 Dimensions: As Shown  
 Scale: As Shown  
 Copyright © Amey  
 Drawing No: **2221A51/1**

Rev  
**P0**